



**STAINLESS STEEL**

**150 LBS SCREWED FITTINGS**

**BSPP (ISO 228-1), BSPT (ISO 7-1), NPT THREAD**

DIMENSION CONFORM TO ASME B16.3 AND ANSI/MSS SP-114-2018 WHERE APPLICABLE

MATERIAL CONFORM TO ASTM A351 GR. CF8 & CF8M

PRESSURE-TEMPERATURE RATINGS 300 PSI (-29 TO 66°C)

MADE BY LOST WAX INVESTMENT CASTING

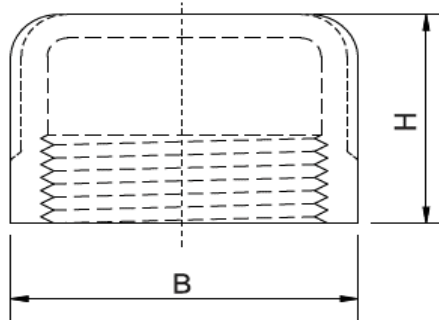

**ROUND CAP**

SIZE	B	H	Weight
	(mm)	(mm)	(Kg/Pc)
1/8"	14.0	17.0	0.01
1/4"	17.2	18.0	0.02
3/8"	21.0	18.0	0.02
1/2"	26.2	20.0	0.03
3/4"	32.5	22.0	0.05
1"	39.8	26.0	0.08
1 1/4"	49.0	28.0	0.12
1 1/2"	55.7	31.5	0.17
2"	68.4	34.2	0.25
2 1/2"	90.0	37.5	0.63
3"	100.0	39.0	0.70
4"	127.5	39.5	1.18